

Voltage Converter **Model VC960** | Operation Instructions

Important Notes

- Store the unit with about 50% battery charge. Do not store with a fully charged battery for a prolonged period of time
- Do not Store in secure location, avoiding the possibility of short circuiting unit's battery adapter terminals
- Keep away from heat

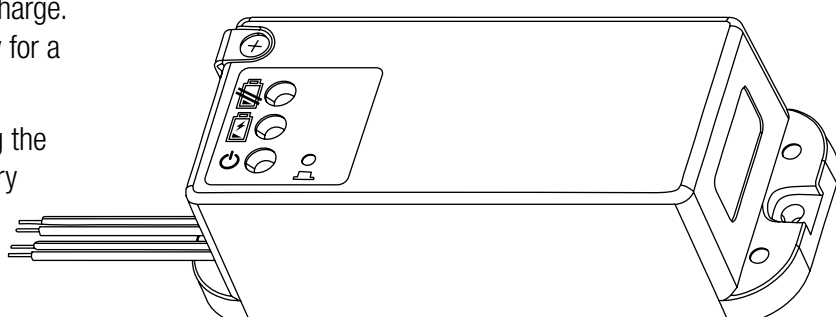

Activation

To Activate the VC960 after installation connect the VC960 to a power source or Press the button shortly. The three leds will blink shortly to indicating that the unit is ready for use.

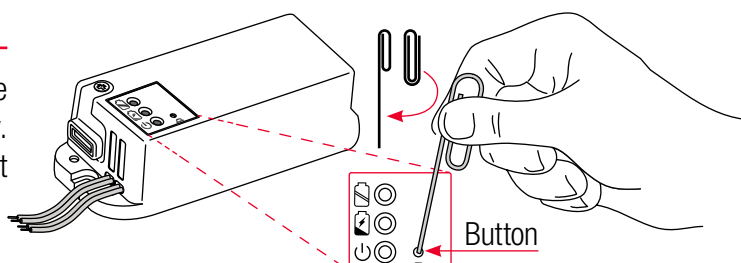

Power Indication

Green Led indicates voltage supply is normal.

Note: If the unit is connected to power but green led is OFF, see Fuse Changing instructions below.

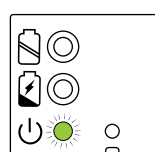

Orange Led indicates backup battery is charging

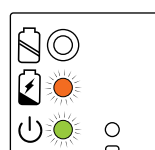

To power off the unit, disconnect it from power grid and press and hold the button for a few seconds until leds are blinking. 3V output is now OFF.

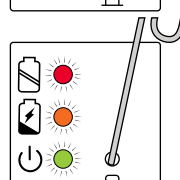

Battery Indication

When green led is OFF, the unit is operated by the rechargeable backup battery.

To receive indication of the battery's condition Press the button shortly.

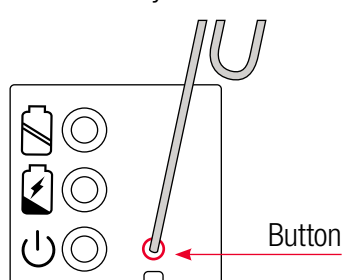

Battery Full

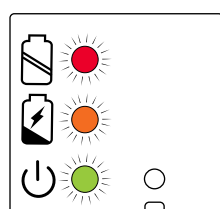

All leds lit

Battery half charged

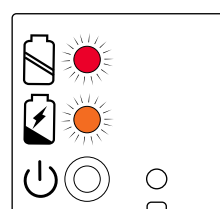

Red and Orange leds lit

Battery Low

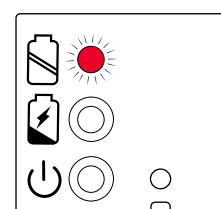

Red led lit

Malfunction Indication

If the red led is lit while power is on, there is a system malfunction.

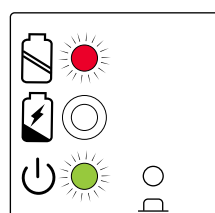

Fuse replacement

If the unit is connected to power but the green led is OFF, the fuse may need replacement.

To replace the fuse:

- Remove the fuse lid
- Pull out the fuse
- Replace with a new fuse:
MINI Blade fuse (automobile supply).
Current Rating 3A
Voltage Rating 32VDC
- Re-Install the cover

